

Port Forwarding on HUAWEI HG8247W5

1. Type 192.168.1.1 then press Enter

- User Name = admin
- Password = enter letters shown in Default Password
- Press Log In

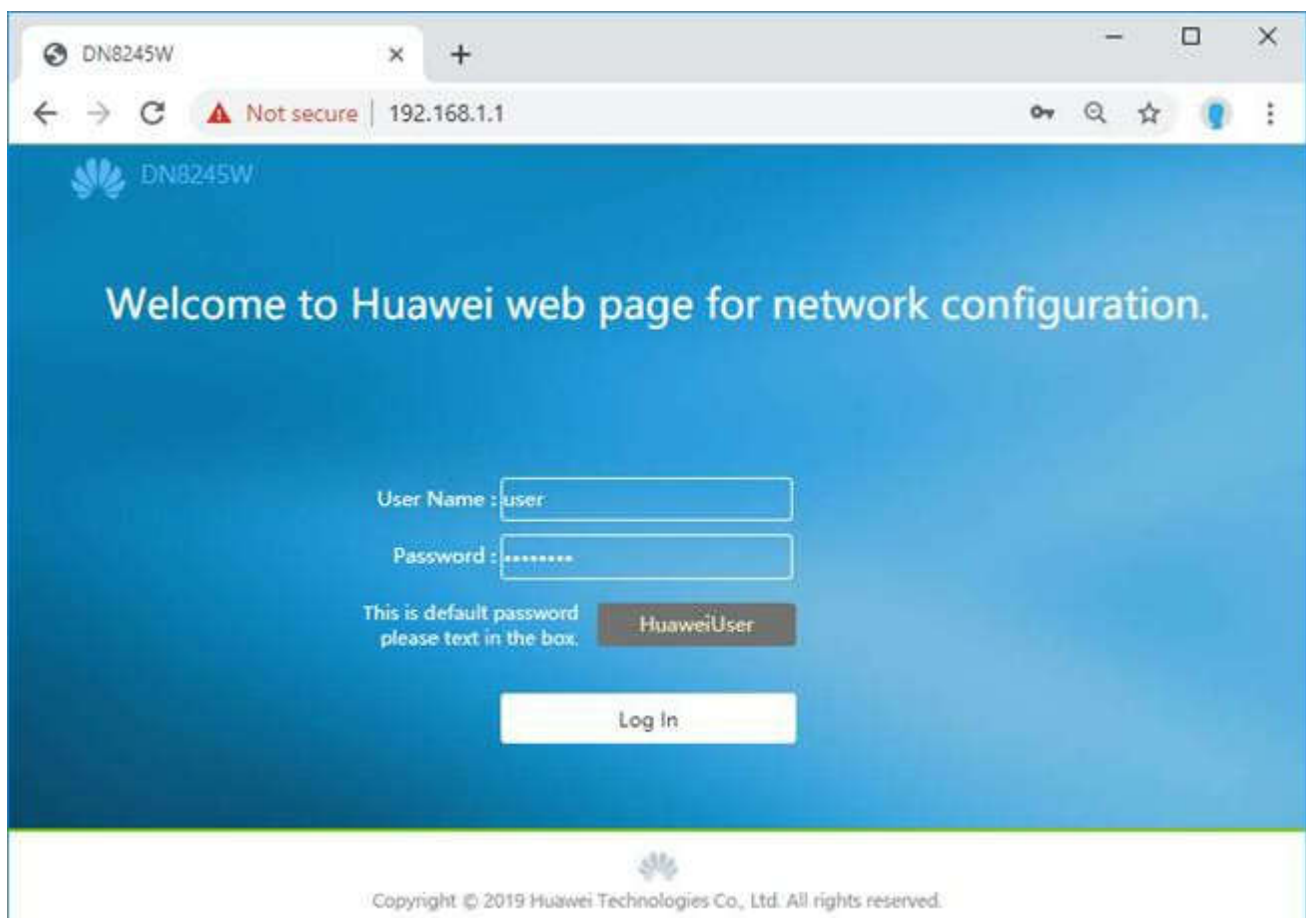

2. Advanced Configuration > Forward Rules > IPv4 Port Mapping

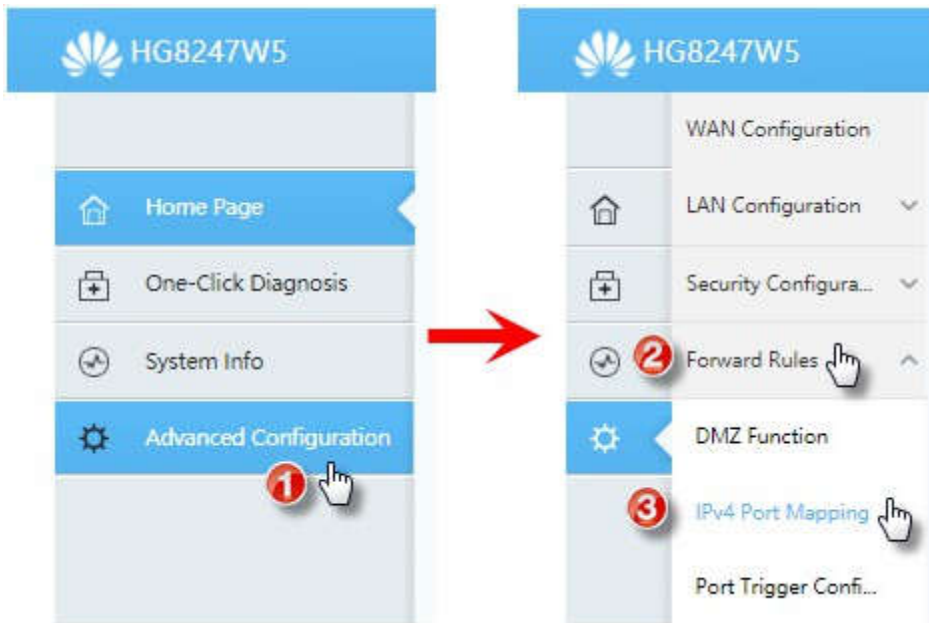

3. Set up as follows:

- Press New
- Type : select User-Defined
- Enable Port Mapping : click a check to enable
- Mapping Name : name this Profile to know the purpose of Port Forwarding e.g. DVR that means Forward Port to DVR
- Internal Host : enter IP Address of device to forward port e.g. DVR will get IP 192.168.1.108 then enter this IP
- When completed, press Apply
- Press Add

IPv4 Port Mapping

On this page, you can set port mapping parameters to set up virtual servers on the LAN network and allow these servers to be accessed from the Internet.
 Note: The well-known ports for voice services cannot be in the range of the mapping ports.

1.

Mapping Name	WAN Name	Internal Host	External Host	Enable
----	----	----	----	----

2. Type: User-defined Application

Application:

3. Enable Port Mapping:

4. Mapping Name:

WAN Name:

5. Internal Host:

External Source IP Address:

7.

6.

4. Set up Port

- Protocol : select protocol per use, if do not sure, select TCP/UDP
- Internal port number : enter Port number of device to forward Port
- External port number : : enter Port number of device to forward Port (if it is True DDNS, enter Port number received from True DDNS)
- When completed, press Apply

IPv4 Port Mapping

On this page, you can set port mapping parameters to set up virtual servers on the LAN network and allow these servers to be accessed from the Internet.
Note: The well-known ports for voice services cannot be in the range of the mapping ports.

Mapping Name	WAN Name	Internal Host	External Host	Enable
----	----	----	----	----

Type: User-defined Application

Application:

Enable Port Mapping:

Mapping Name:

WAN Name:

Internal Host:

External Source IP Address: --

Protocol: 1 2 Internal port number: --

External port number: -- 3 External source port number: --

4

5. Thereafter you'll find mapping parameters shown in a table on the top

IPv4 Port Mapping

On this page, you can set port mapping parameters to set up virtual servers on the LAN network and allow these servers to be accessed from the Internet.
 Note: The well-known ports for voice services cannot be in the range of the mapping ports.

Mapping Name	WAN Name	Internal Host	External Host	Enable
<input type="checkbox"/> DVR	1_TR069_INTERNET_R_VID_100	192.168.1.108	--	Enable

Type: User-defined Application

Application:

Enable Port Mapping:

Mapping Name:

WAN Name:

Internal Host:

External Source IP Address: --

Protocol: Internal port number: --

External port number: -- External source port number: --