

How to turn on/off Data usage on TRUE BEYOND TAB 3G

1. Select Settings

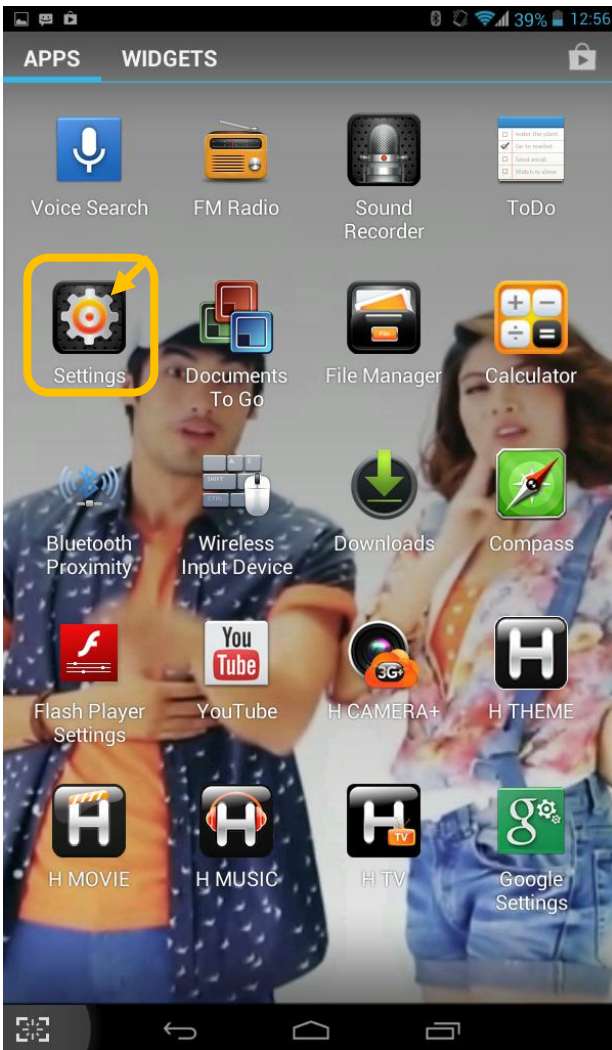

2. Data usage

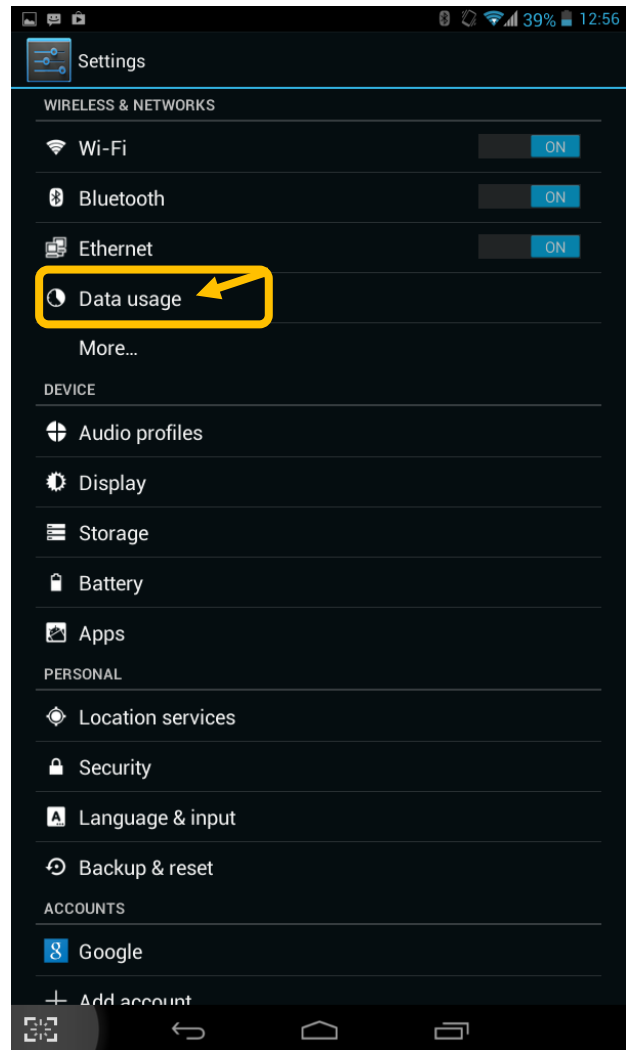

3. Select Mobile Data to turn on/off data usage

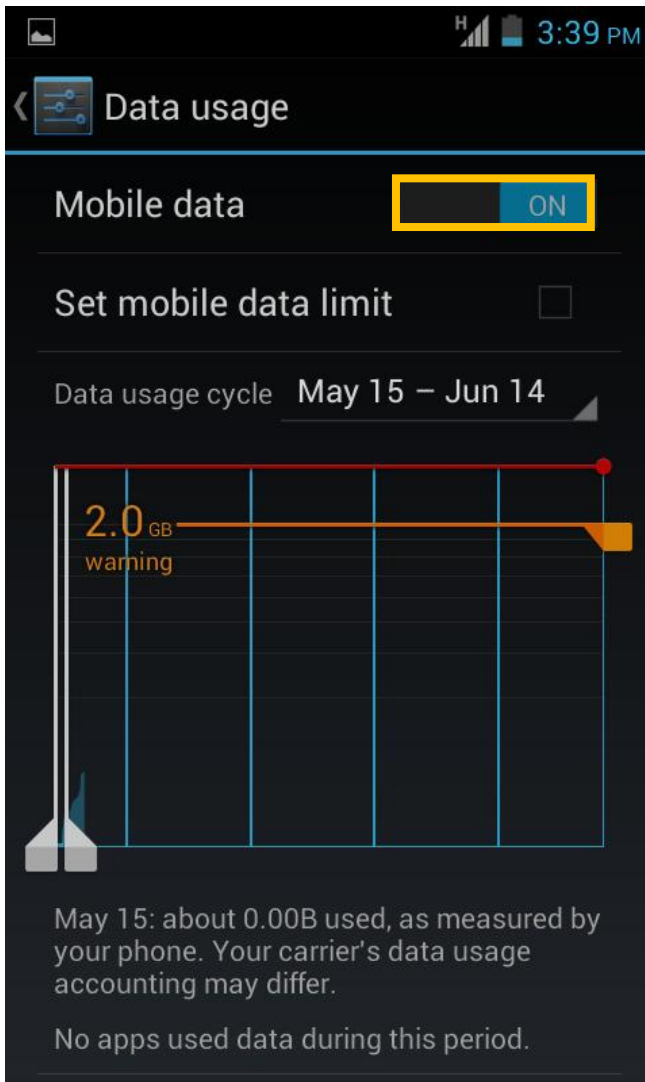

4. Select Set mobile data limit to set the limit of your data usage to not be over the red line.

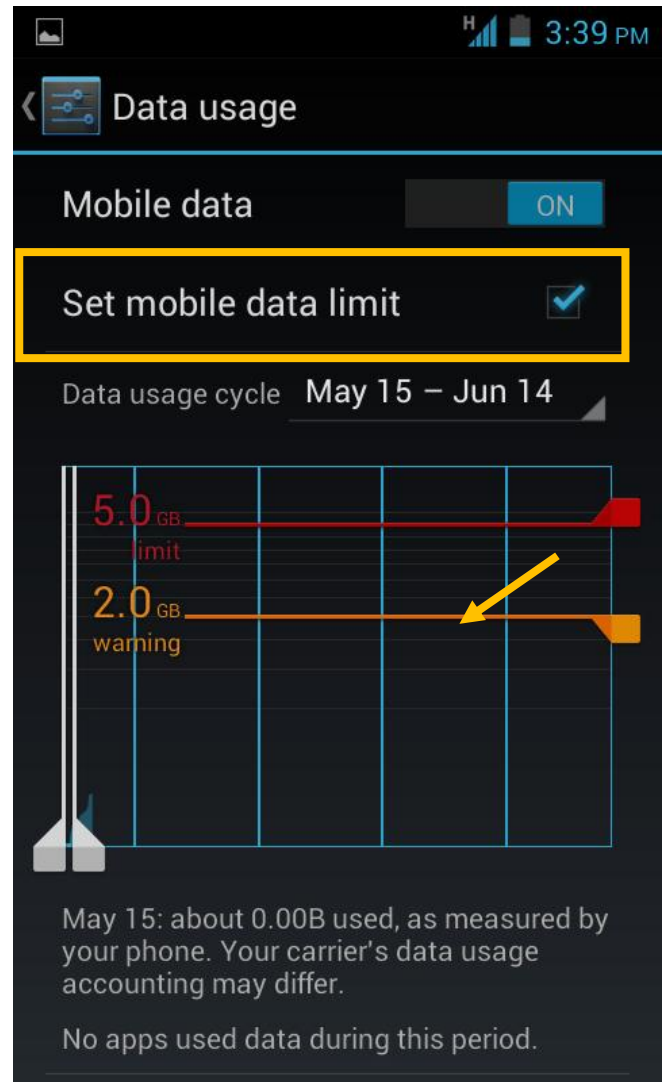

5. The yellow line is to set when to start the warning

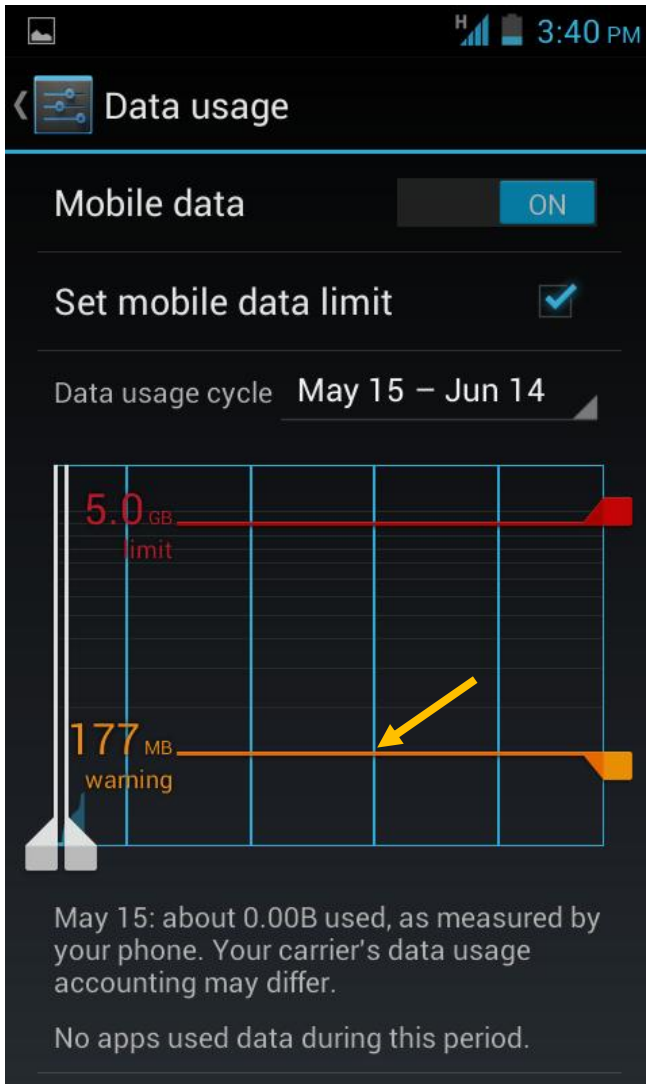

6. Data usage warning appears if your data usage is over the set yellow line



7. Select Data usage warning

8. This can be changed to coincide with your billing cycle

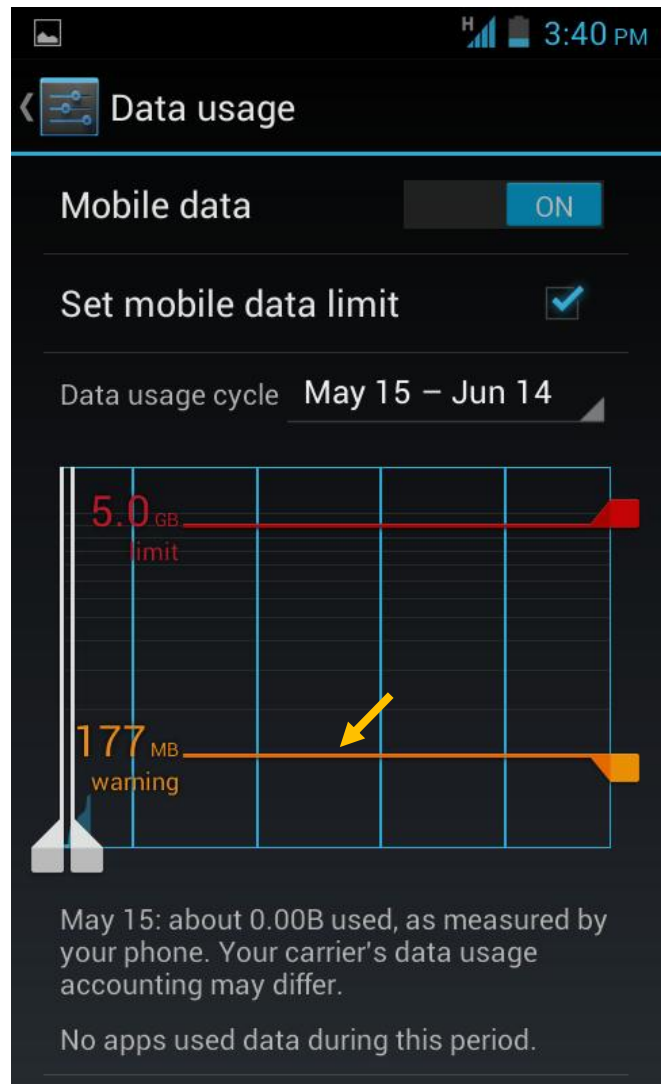
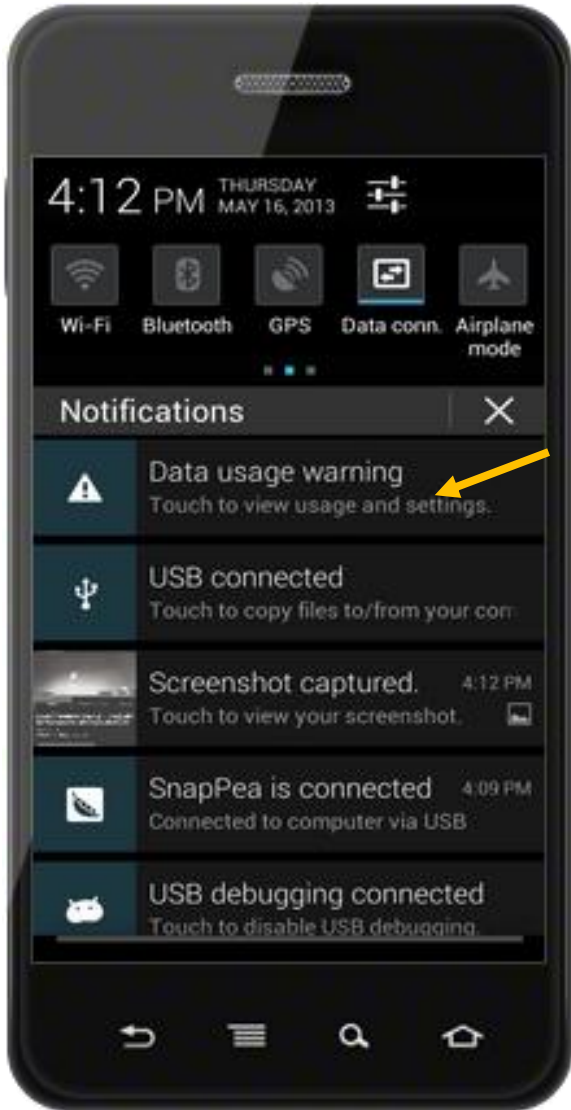

9. The warning can be changed to coincide with the billing cycle.

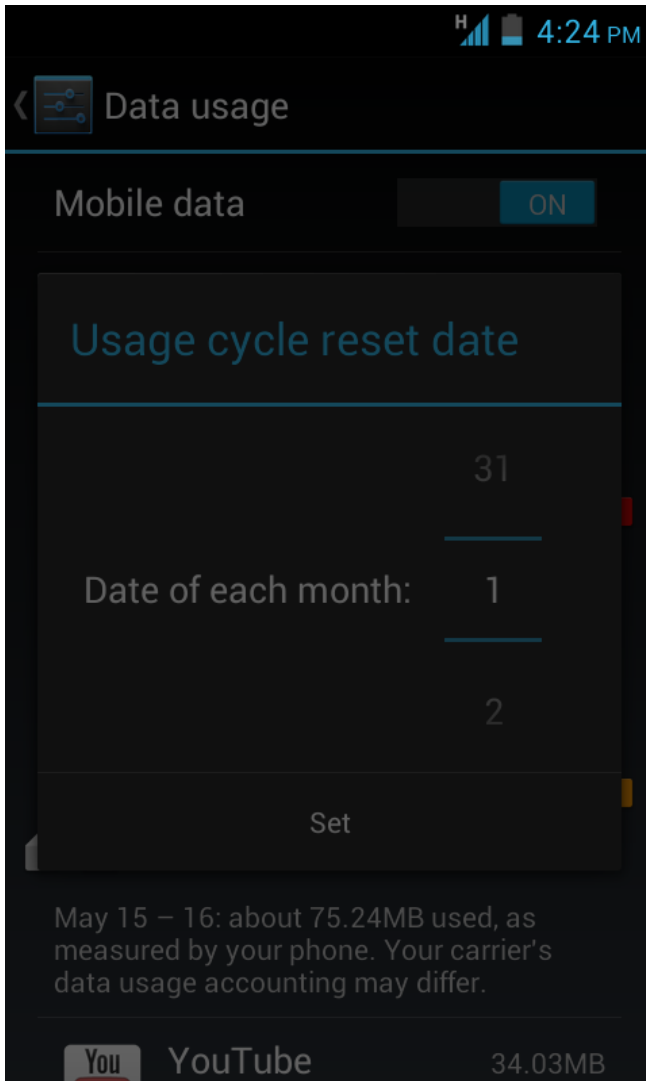

10. After changing the usage cycle

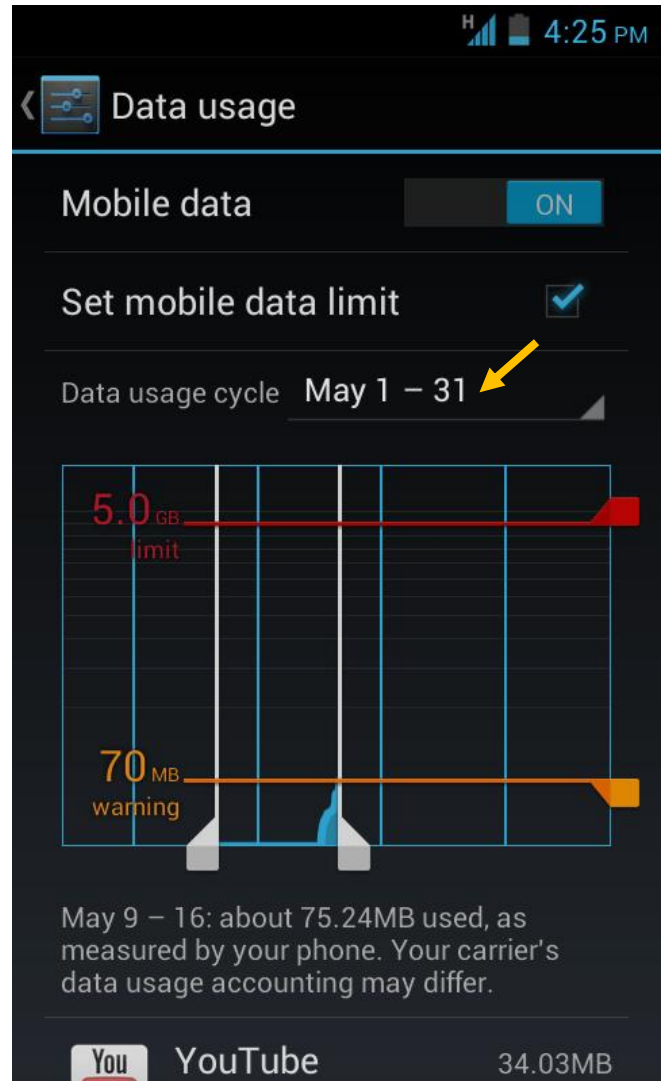

11. Data usage by each application can be checked.

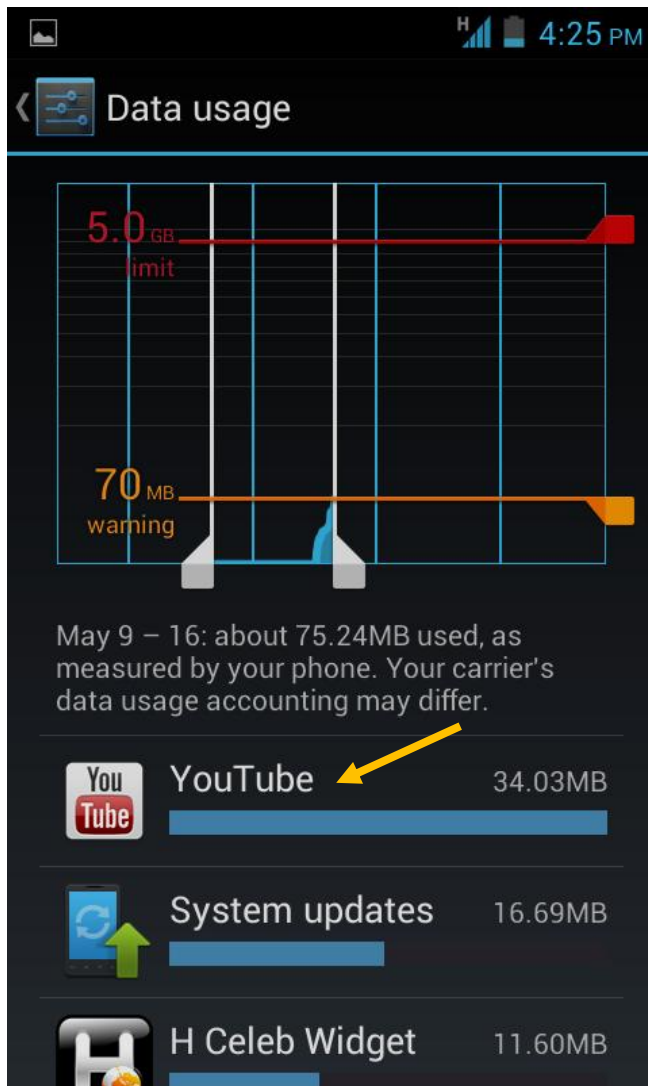

12. Both Foreground and Background data usage can also be checked.

