

How to restore Factory setting for 4G Pocket WiFi

1. Press and hold Power button



2. Wait until the device shows normal LED



3. Use clip or SIM Eject Tool into a Reset hole

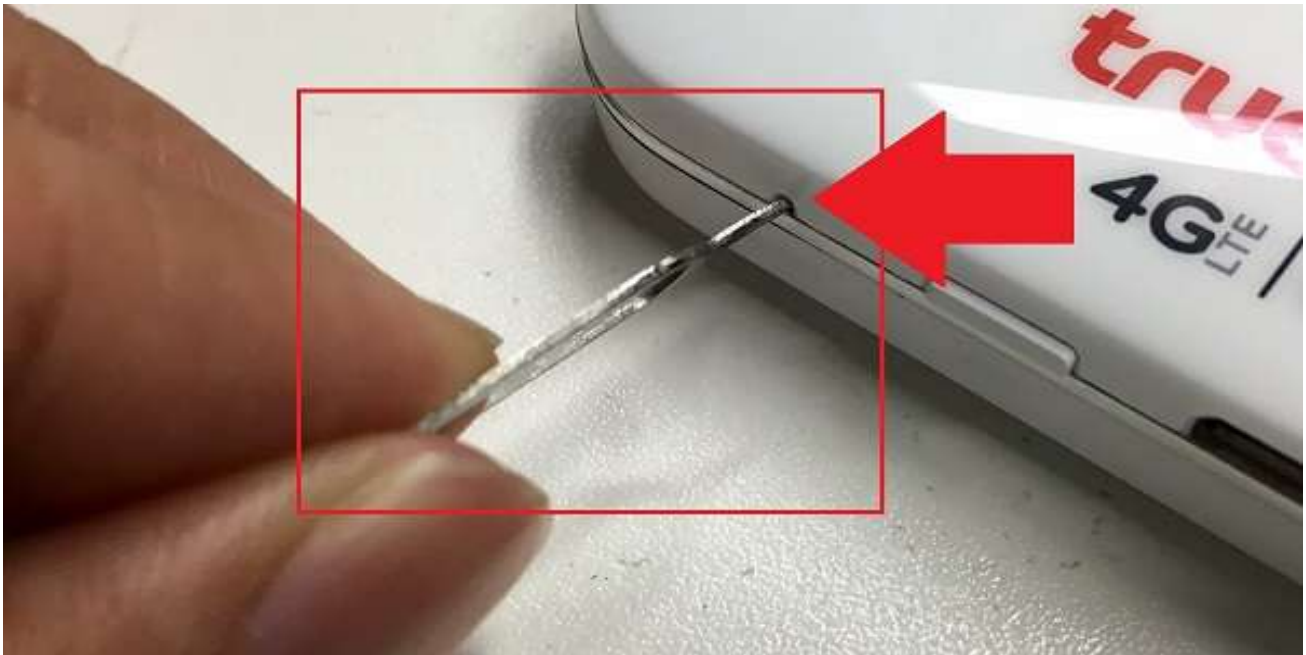

4. LED light will be on only the 1st one (mobile network) and the 4th one will be red (battery)



5. Wait a moment, the device will turn off and on, 4 LED lights will turn green



6. 1st and 4th LED will be red, 2nd and 3rd LED will be green and then release the clip or SIM Eject Tool from a Reset hole



7. Wait until 1st, 2nd and 4th LED are green which means the device is ready to use

3rd LED (SMS) will show when there's incoming SMS and not yet read

